



CIRCLE
S
PRODUCTS, INC.

TECHNICAL BULLETIN

TYPE: Horizontal flow
installations only (Cast Iron)
MODEL: Dry-Flo™ T Moisture Separator
TB No. S3865

Date 1-99

Gas laden with moisture, enters the inlet of the separator where a deflector plate directs the flow in a downward centrifugal motion. The entrained moisture is then separated out of the flow by a reduction in velocity. The separated liquid is sent to the outer walls of the separator and falls below the re-entrainment breaker plate where it is prevented from reentering the flow stream. A dry, clean flow then results, exiting upward through the outlet of the separator.

With correct sizing and proper drainage, these separators are designed to eliminate 99% of all entrained liquids and particles that are 10 microns and larger in size.

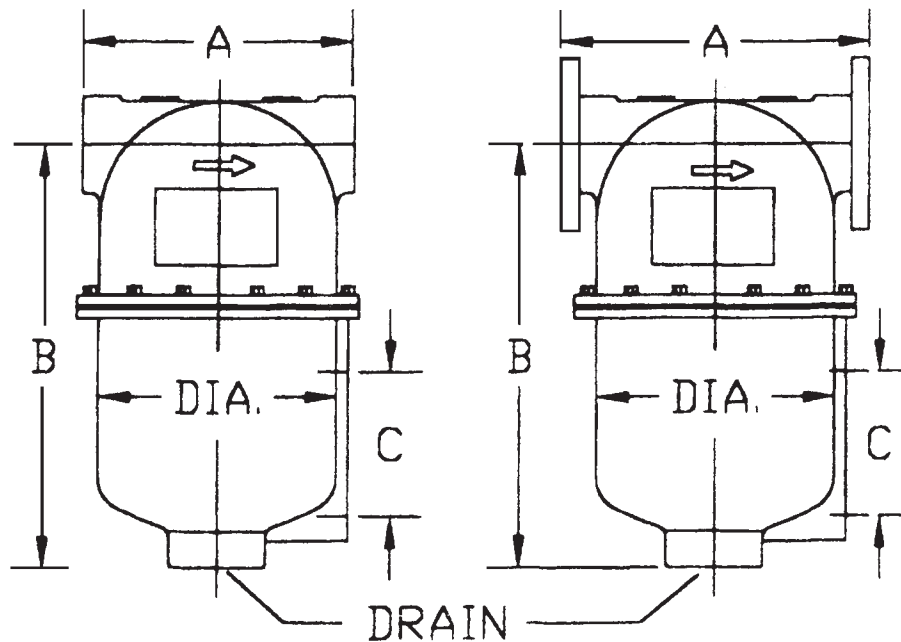

DIMENSIONS AND WEIGHTS

SIZE	A	B	C	DIA.	DRAIN	P(PSIG)	T (°F)
1 1/2" NPT	7 1/2"	11 5/8"	4 3/4"	5 1/4"	1 1/2"	160	450
2" NPT	8 1/8"	13"	4 3/4"	6 5/8"	1 1/2"	160	450
2 1/2" NPT	9 3/8"	15"	4 3/4"	7 3/4"	1 1/2"	160	450
3" NPT	11"	16 1/4"	4 3/4"	9 1/8"	2"	160	450
4" FLG'D	15 7/8"	19 1/2"	5 3/4"	11 1/4"	2"	150	450